

KWIK HUS	h_1^*	t_{fix}
$\frac{3}{4} \times 4\frac{1}{2}$	$4\frac{7}{8} - t_{fix}$	0... $\frac{1}{2}$
$\frac{3}{4} \times 5\frac{1}{2}$	$5\frac{7}{8} - t_{fix}$	0... $1\frac{1}{2}$
$\frac{3}{4} \times 7$	$7\frac{3}{8} - t_{fix}$	0...3
$\frac{3}{4} \times 9$	$9\frac{3}{8} - t_{fix}$	0...5

SIW 22T/18T-A	✓	✓
SIW 9-A22	✓	⊘
	95 ft-lb	

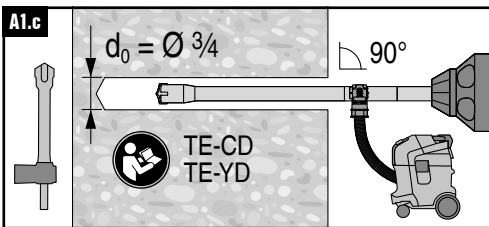

*For non-hole cleaning installation (steps A1.a or A1.b), make sure to drill deep enough to achieve h_1 , taking into account the depth of debris remaining in the hole

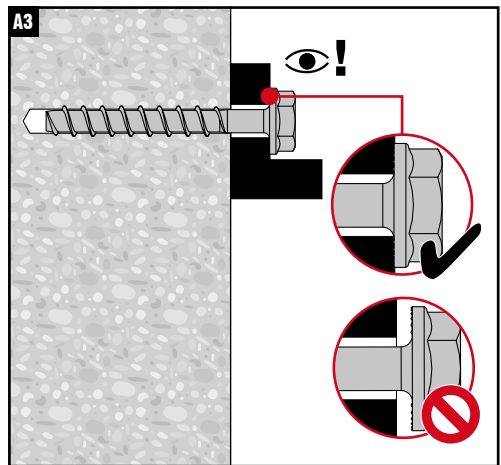
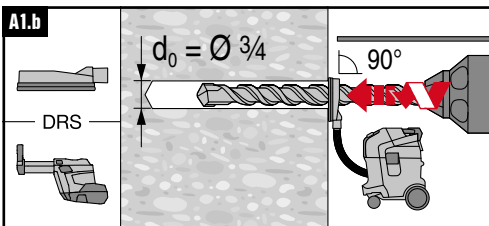
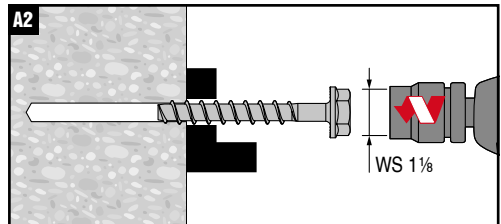
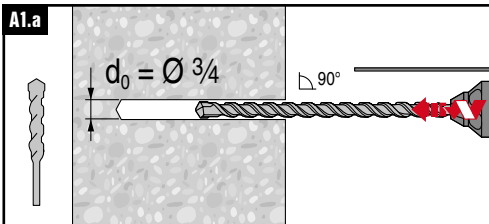
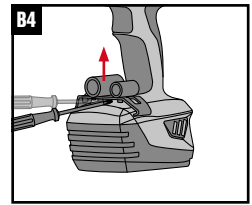
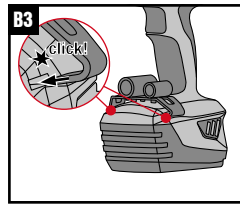
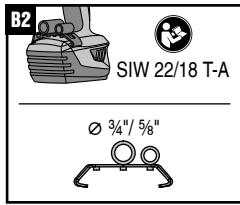
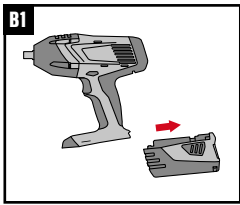
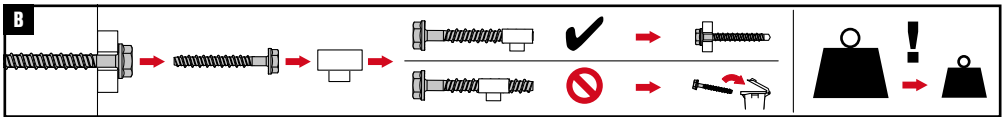

< 3000 psi	
SIW 22T/18T-A	✓
	95 ft-lb

≥ 3000 psi	
SIW 22T/18T-A	✓
	95 ft-lb

